



St. Charles Park District



Enriching Your Life

A National Gold Medal Award Winner for Excellence in Park and Recreation Management

Bond Referendum Informational Summary ■ ■ February 5, 2008 ■ ■ General Primary Election



Background

On November 27, 2007, the Board of Park Commissioners unanimously approved placement of a referendum question on the February 5, 2008 ballot. The information contained herein is designed to inform residents about the referendum.

What is the Referendum Question?

Shall bonds of the St. Charles Park District, Kane and DuPage Counties, Illinois, to the amount of Twenty-Five Million Dollars (\$25,000,000) be issued for the purpose of acquiring land for park and recreational purposes and building, equipping, maintaining and improving parks, land and facilities of said Park District including constructing a pool complex at Campton Hills Park, renovating the Pottawatomie Park Pool, constructing an Environmental Education Center and improving the District's athletic facilities and neighborhood parks?

The Planning Process

Responding to community needs, the Board of Park Commissioners appointed three committees composed of a cross-section of community residents. The Athletic, Environmental Programs & Facilities, and Aquatics Ad hoc Advisory Committees met over a series of months to review and discuss program and facility needs and made their recommendations to the Park Board for its review. In addition to taking committee recommendations into consideration, the Park Board considered capital improvement priorities and land acquisition needs as set forth in the Park District's Comprehensive Master Plan. Referendum needs were thoroughly discussed by the Park Board in public meetings prior to arriving at the \$25 million dollar figure.

Due to funding constraints placed on the Park District by the Illinois "Tax Cap," the District does not have the capability of funding all projects without voter approval.



Why is the Referendum on the Ballot?

- The Park District has experienced substantial population growth over the past 20 years. Open space and natural areas are disappearing while the demand for open space and new facilities continues to grow.
- A variety of neighborhood park improvement projects will be addressed by this referendum. Planned improvements by park site are presented below.
- The Board of Park Commissioners has determined that improvements to our community's athletic facilities are needed. The Park District provides athletic facilities that serve over 13,600 participants affiliated with the Tri-Cities Soccer Association, Strikers Fox Valley Soccer Club, Campton United Soccer, Tri-City Youth Football, St. Charles Boys' Baseball Association, St. Charles Girls' and Women's Softball Association, St. Charles Boys Lacrosse, Fox Valley Rugby Club and Celtics Soccer Club. Additionally, the Park District sponsors athletic programs serving an additional 2,200 participants playing in Men's and Co-Ed Softball leagues.
- The District's environmental education program has grown substantially over the years. The program now reaches over 7,000 youth and adults annually through environmental education programs offered to the general public and Community Unit School District 303 elementary school students. The Park District currently does not have an environmental education center, nor does it have adequate classroom space to serve existing program participants.
- Pottawatomie Pool was developed during the great depression 70 years ago to serve a population of about 7,000 residents. Today, approximately 46,500 people reside in the Park District. Much of the pool's infrastructure is old and must be updated or replaced.
- In 2007, 89,000 individuals visited Pottawatomie Pool and Campton Hills Splash Park. These facilities are crowded and more pool space is necessary to meet demand. Demand for swim lessons exceeds capacity. In 2007, 1,675 participants registered for swim lessons while 130 remained on the waiting list. The summer youth swim team is at capacity with 107 swimmers; others remain on the waiting list.
- Maximum attendance was reached at the Campton Hills Splash Park on numerous days within one hour after opening, creating long lines to use this facility.



Acquisition of Open Space – \$2,000,000

- Acquisition of undeveloped land will provide sites for recreational use, protect wildlife habitat, preserve native woodland, prairies and wetlands and help to protect the Fox River watershed while providing flood relief and enhancing water quality.
- Preservation and protection of open space for future generations – natural areas and other undeveloped land is rapidly disappearing while demand for such areas grows as the population increases.
- The Board of Park Commissioners believes that maintaining a proper balance between development and park land enhances property values and our quality of life.

Improvements to Neighborhood Parks – \$796,075

Charlemagne/Kingswood Park

- Replace 18 year old playground structure to meet current safety standards

Cambridge Park

- Replace 17 year old playground structure to meet current safety standards

Taly Park

- Replace 17 year old playground structure to meet current safety standards

Surrey Hill Park

- Replace 14 year old playground structure to meet current safety standards
- Landscape enhancements

Timber Trails Park

- Install a new playground unit in the western portion of the park site
- Rehabilitate fishing pier
- Remove invasive vegetation at park site

Langum Park

- Repave and color coat existing tennis courts
- Replace leaking concrete ice rink/parking lot surface

Dunham Pond

- Stabilize shoreline and repair erosion at the pond
- Rebuild walking path surrounding pond
- Replace split rail fencing
- Install a 3rd aerator in the pond to reduce algae growth

Cranston Meadows Park

- Expand and modernize 17 year old playground structure
- Landscape enhancements

Renaux Manor Park

- Construct a basketball court
- Plant native landscaping around perimeter of park site

Rotary Park

- Pave walkways throughout the park
- Construct a gazebo

Primrose Farm Park

- Construct a new playground structure
- Repave and color coat tennis courts
- Landscape the park site and plant a native buffer around the perimeter

Delnor Woods Park

- Stabilize leaking dam along existing pond

Lincoln Park

- Renovate gazebo and concrete plaza
- Landscape enhancements

Boy Scout Island

- Stabilize eroding shoreline



Improvements to Our Community's Athletic Facilities – \$1,005,000

East Side Sports Complex

- Light two soccer fields and one football field to serve almost 11,000 youth and adults participating in league play.
- Construct two shelters to serve the 8 existing ball diamonds at the park site. Both shelters will serve approximately 3,000 youth and adults who use the park for league play. Shelters will protect participants from inclement weather and provide space for program functions.
- Construct restrooms served by city sewer and water to eliminate existing pump out vaults.
- Resurface the basketball courts and bike/pedestrian trail and construct a small storage building to serve the park site.

Langum Park

- Construct 4 new dugouts to protect the 600 youth participating in softball programs.

Davis Park

- Replace the backstop and sideline fencing on one baseball field to better serve the 1,200 youth participating in youth baseball programs.

Environmental Education Center – \$4,000,000

- The District believes that the center, to be located at Campton Hills Park, will encourage lifelong learning about the environment and a greater appreciation for the natural world. The facility will demonstrate environmentally friendly practices that visitors can utilize in their own homes.
- The Environmental Education Center will provide flexible classroom space to enhance the educational experience of 5,300 students who annually attend Park District sponsored environmental education programs as an integral component of District 303’s science curriculum and the Park District’s summer nature camp programs.
- Construct indoor space for interpretive exhibits to initiate the learning experience and orient the visitor to nature, the environment and natural sciences they will explore along the outdoor trails.
- Construct an inviting center for attracting and training local volunteers that are essential to the restoration work in Campton Hills Park and other Park District natural areas.
- Provide an accessible learning facility useable by families and individuals throughout four seasons.



Proposed Environmental Education Center

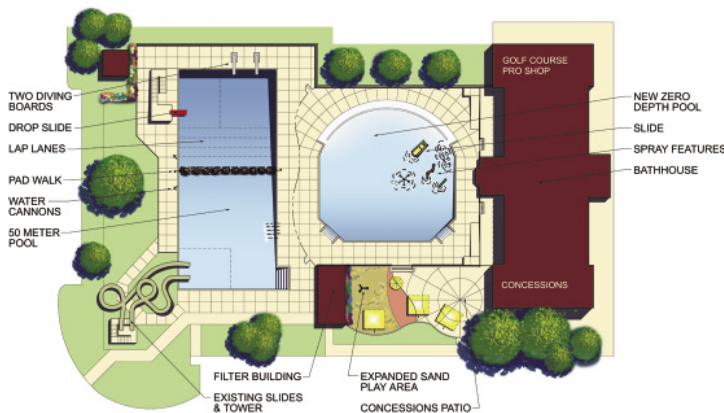

Pottawatomie Pool Renovations

Swimming Pools

Pottawatomie Pool will be renovated – \$6,298,160

- Renovate the 70 year old Pottawatomie Pool to better serve all ages. Improvements include: making the smaller pool into a zero depth pool, and adding interactive play features for children. The large pool will expand slightly to 50 meters in length making it useable for competitive use, a second diving board will be added, and the diving well will be made deeper to comply with current state codes. Locker rooms will be renovated to include family restrooms. Necessary infrastructure improvements include a new filtration gutter and piping system, building improvements, and a renovated concession stand.



Campton Hills Pool Complex

A new pool complex will be developed at Campton Hills Park – \$10,900,765

- Construct a pool complex at Campton Hills Park designed for family members of all ages with features that include: a zero depth activity pool, 8 lap lanes, a shallow toddler pool, body, tube and drop slides, diving boards, Lazy River, family restrooms, stage area, and concessions.

The Park District projects, when revenues from both pools are combined, the admission and program fees will fully cover the operational costs of both facilities.

How Much of Your Property Taxes Currently Go to the St. Charles Park District?

In 2007, a typical City of St. Charles taxpayer paid 6.3% of his/her total property tax bill to the St. Charles Park District. 93.7% of the local property taxes paid by a City of St. Charles taxpayer went to all other local taxing bodies. This percentage will vary slightly if you reside in South Elgin, Wayne or in an unincorporated area.

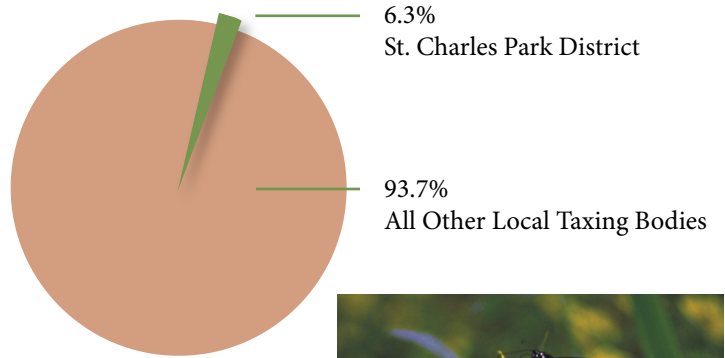

The Cost of the Referendum

With passage of the referendum, the Park District will sell bonds that mature over a 20 year period. The average cost to homeowners would be as follows:

Home's Market Value	Annual Cost to Homeowner	Monthly Cost to Homeowner
\$100,000	\$14.77	\$1.23
\$200,000	\$29.95	\$2.50
\$300,000	\$45.69	\$3.81
\$400,000	\$61.74	\$5.15

Once the bonds are paid off, the above tax will be eliminated.

All Grant Opportunities will be Pursued

The Park District will actively seek available local, state and federal land acquisition and development grants to provide financial assistance for all major eligible projects. Over the last 17 years, the Park District has successfully received over \$9 million dollars in grants and gifts to augment local funding and enhance park sites.



The mission of the St. Charles Park District is to enrich the quality of life of Park District residents through excellence in programs, parks, facilities and services.



St. Charles Park District
101 S. Second Street
St. Charles, IL 60174

www.st-charlesparks.org

St. Charles Park Board

- Gloria Klimek, President
- Nancy A. Cox, Vice President
- John Kerr, Treasurer
- John Forni, Assistant Secretary
- James F. Cooke, Commissioner
- Karrsten Goettel, Commissioner
- Bob Thomson, Commissioner
- James O. Breen, Director & Park Board Secretary

For more information, call (630) 584-1055.

